

JETCORE WARRANTY INFORMATION SHEET

LIMITED LIFETIME RESIDENTIAL WARRANTY:

TP Brands Worldwide, Inc provides a Limited Lifetime Warranty for residential installations, when installed in accordance with the published Homestead Flooring installation instructions. This warranty provides that the flooring purchased will be free of manufacturing defects. This applies to new, first quality product only. TP Brands Worldwide, Inc warrants that there will be no wear-through of the wear layer. Wear Through is defined as surface that has been worn to such an extent as to expose and damage the core material. This “wear through” **must** be present in over 5% of the total installation. Products that were determined to be defective or damaged resulting from improper installation would not constitute a valid claim under this Limited Warranty. TP Brands Worldwide, Inc. reserves the right to inspect any claim and request photographs and/or samples prior to approving such claim. This warranty is non-transferable and valid to the original purchaser only.

LIMITED RESIDENTIAL WEAR LAYER WARRANTY DOES NOT COVER:

1. Damages due to adhesives or tape, pets, lack of proper furniture pads or any intentional misuse of the product.
2. Scratches, gouges, scuffs, punctures, cuts, accidental indentations, and burns caused by abuse and excessive wear and tear. Loss of finish gloss over time is consistent with normal wear & tear and is not a product flaw. Dull finish can be corrected with spot or overall recoating care systems.
3. Defects caused by extended exposure to UV light and/or direct sunlight. Please see installation instructions for proper protective measures.
4. Noncompliance with installation instructions and maintenance guidelines as recommended by TP Brands Worldwide, Inc.
5. Floor covering installed in inappropriate locations including but not limited to the outdoors is excluded from this warranty.
6. Any damages to other areas or components of the structure.
7. If rubber-based rug pads are used on top of the Homestead Flooring, which potentially can cause discoloration to the flooring will not be covered by this warranty.

15 YEAR EXCLUSIVE LIGHT COMMERCIAL WEAR LAYER WARRANTY:

TP Brands Worldwide, Inc. provides a 15-year Limited Warranty for Light Commercial Installations, when installed in accordance with the published Homestead Flooring installation instructions. This warranty provides that the flooring purchased will be free of manufacturing defects. This applies to new, first quality product only. TP Brands Worldwide, Inc. warrants that there will be no wear-through of the wear layer. Wear Through is defined as surface that has been worn to such an extent as to expose and damage the core material. This “wear through” **must** be present in over 5% of the total installation. Products that were determined to be defective or damaged resulting from improper installation would not constitute a valid claim under this Limited Warranty. TP Brands Worldwide reserves the right to inspect any claim and request photographs and/or samples prior to approving such claim. This warranty is non-transferable valid to original purchaser only.

prior to approving such claim. This warranty applies to product installed in the following commercial applications.

- Hotels: Conference & Meeting rooms, Guest rooms and Lobby.
- Retail Shops: Boutiques, Showrooms (Automobile Showrooms excluded) Hair Salons, Display Areas and Entryways. The use of non-rubber walkway mats is required.
- Offices: Meeting and Conference rooms, Offices, Break rooms and other meeting areas.
- Educational: Classrooms, Common Areas, and Residence Halls.

15 -YEAR EXCLUSIVE LIGHT COMMERCIAL LIMITED WARRANTY DOES NOT COVER:

1. Damages due to adhesives or tape, pets, lack of proper furniture pads or any intentional misuse of the product.
2. Everyday wear and tear including scratches, gouges, scuffs, punctures, cuts, or accidental indentations, burns, Loss of finish gloss over time is consistent with normal wear & tear and is not a product flaw. Gloss reduction or surface scratches are not considered surface wear. Dull finish can be corrected with spot or overall recoating care systems.
3. Defects caused by extended exposure to UV light and/or direct sunlight
4. Noncompliance with installation instructions and maintenance guidelines as recommended by TP Brands.
5. Floor covering installed in inappropriate locations is excluded from this warranty.
6. Any damages to other areas or components of the structure.
7. If rubber-based rug pads are used on top of the Homestead Flooring, which potentially can cause discoloration to the flooring will not be covered by this warranty.

LIFETIME LIMITED WATERPROOF WARRANTY

The floor plank or tile is warranted to be 100% waterproof and the integrity of the floor plank will not be significantly reduced by exposure to water for the life of the product. If the floor plank, as a result of exposure to water, is determined to be significantly diminished, TP Brands Worldwide, Inc. will arrange a pro-rated credit based on the terms outlined below. As moisture may accumulate in any structure or on the surfaces of many building materials, mold and mildew growth may occur. This product will not act as, nor is it represented to be, a water barrier for the subfloor or any other component of the structure. Damage from mold and mildew is expressly excluded from any part of this warranty. This warranty is NOT transferable by the original purchaser of the floor.

LIFETIME LIMITED WATERPROOF WARRANTY DOES NOT COVER:

1. Any other component or structural aspect of the installation site. Damage to surrounding structure, walls, subfloor, fixtures, furniture, underlayment, moldings, trims, subfloor heating elements, or anything that is not the floor plank.
2. Damage resulting from mold & mildew growth due to prolonged exposure to moisture.
3. Flooring that is installed outdoors.
4. Any water damage other than damage which diminishes the integrity of the floor plank itself.

TERM OF LIMITED WARRANTIES

ALL CLAIMS MUST BE SUBMITTED IN WRITING AND APPROVED BY TP BRANDS.

WITHIN 1 YEAR:

If product is found to be defective, TP Brands Worldwide, Inc. will supply replacement products of the same or similar style, size, color, grade and gauge for the area determined to be defective. TP Brands Worldwide, Inc. will pay reasonable labor cost if it was professionally installed or will repair the defect. Prior to any action being taken, TP Brands Worldwide, Inc. must approve in writing, the cost of labor by a professional installer. TP Brands Worldwide, Inc. will pay 100% of reasonable and approved labor claims within the first year.

YEARS 2 - 5:

Between Year One - Five: Claims on defects of this product, as covered by this warranty, that are reported in writing after YEAR 1, but within 5 years of purchase, TP Brands Worldwide, Inc. will arrange a credit based on the original purchase of the product or replace the product.

YEARS 5 -10:

Between Year Five - Ten: Claims on defects of this product, as covered by this warranty, that are reported in writing after five Years, but within ten years of purchase, TP Brands Worldwide, Inc. will provide a credit based on the original purchase of the product or replace the product.

AFTER 10 YEARS:

Claims that are reported in writing after ten years after purchase date TP Brands Worldwide, Inc. will provide the sufficient replacement amount of the product to repair the defective area of floor or at it's option a credit equal to the value of the original purchase price.

EXCLUSIONS TO LIMITED WARRANTY

- Wear from chairs or other furniture without proper floor protectors will void the warranty.
- Indentations, scratches or surface damage caused by improper maintenance, misuse, negligence,
- Spike heeled shoes, pebbles, sand, pets' claws, or other abrasives are not covered by this warranty.
- Sub-floor irregularities can cause premature wear on the Homestead Flooring plank wear layer and will void the warranty.
- Dissatisfaction due to improper installation or installation contrary to recommendations is not covered by this warranty.
- Problems due to moisture, mildew, alkaline substances, or hydrostatic pressure in the sub-floor are NOT covered by this warranty.
- Using non-recommended floor care products may damage the floor and void the warranty. (e.g. Vinegar or vinegar-based cleaners).
- Purchase of "seconds", "remnants", "mill trials" or other "irregular" (non-first quality) flooring material, or material not part of, or available from TP Brands Worldwide, Inc are not warranted.
- The warranty only applies to new installs. This warranty does not apply to any re-install of product.
- Dissatisfaction or damages caused by improper installation or maintenance.
- Damage resulting from misuse or abuse including, but not limited to, scratches, cuts, burns, stains, indentation, improper or insufficient maintenance, use of steam cleaners, beater bar vacuums, lack of proper floor protectors and damages caused by pets. Discoloration due to solvent based polishes; cleaners or use of rubber-backed mats will not be covered. Reduction of products gloss is not covered. Fading, Expansion or shrinkage of flooring that is exposed to direct sunlight for extended periods of time will not be covered.

This limited warranty is made solely to the original purchaser of TP Brands Worldwide, Inc. Homestead Flooring products and is NOT transferable under any circumstances. Limited Warranty period begins on date of purchase. This Limited Warranty is expressly in lieu of any other expressed warranty whether oral or written. No representative, employee, or agent of TP Brands Worldwide, Inc. or any other person, is authorized to assume for TP Brands Worldwide, Inc. any additional liability or responsibility in connection with TP Brands products.

IF AFTER READING THROUGH THE ENTIRE WARRANTY SHEET AND YOUR CLAIM IS COVERED UNDER TP BRANDS WORLDWIDE INC.'S LIMITED WARRANTY STIPULATIONS, THE ORIGINAL PURCHASER CAN THEN REACH OUT TO THEIR PURCHASE LOCATION FOR HOW TO FILE A CLAIM. IF NEEDED AN INSPECTOR WILL BE SCHEDULED TO ANALYZE DAMAGE AND DETERMINE ISSUES.

PLEASE READ THROUGH ALL INSTRUCTIONS FOR THE HOMESTEAD FLOORING, JETCORE™ BEFORE INSTALLING TO ASSURE SATISFACTORY INSTALLATION

PRIOR TO INSTALLATION

- DO store cartons horizontally on a smooth, solid, flat, clean surface.
- DO NOT store the cartons directly on concrete, allow for air circulation. Concrete Floor can be up to 10° F Colder than ambient room temperature.
- DO NOT stack higher than ten cartons.
- DO NOT stack anything on top of uninstalled Homestead JetCore™ Flooring.
- DO maintain a minimum of 55° degrees F and maximum of 85° F before, during and after installation.
- DO carefully check flooring material for any defects. Contact your supplier immediately if any defect is found.
- DO be sure to install all base and island kitchen cabinets prior to installing the Homestead JetCore.
- DO NOT install base cabinets or island cabinets on top of the floor.
- DO remove all furniture and appliances from the room, as well as existing quarter round, baseboard molding or cove base.
- DO make sure, before installation, that the subfloor doesn't have more than a 3/16" difference in level over a 10'x10' area.
- DO undercut doorway moldings to be the thickness of the flooring.
- DO be sure to read through all the installation instructions and warranty information before starting the installation.
- DO NOT install your Homestead JetCore over soft subfloors such as carpet. This product is recommended for INDOOR use ONLY.
- DO prepare existing subfloor according to the instruction below. Failure to do so will void the manufacturer's warranty.
- DO NOT install this product over any subfloor with non-embedded radiant heat. (Please see section on radiant heat).

WARRANTY NOTE:

PLEASE EXAMINE FLOORING FOR COLOR AND QUALITY BEFORE INSTALLATION. OUT FLOORING IS MANUFACTURED IN ACCORDANCE WITH INDUSTRY STANDARDS. IF MATERIAL IS OF UNSATISFACTORY QUALITY, PLEASE CONTACT THE SELLER IMMEDIATELY. UNDESIRABLE PIECES SHOULD NOT BE INSTALLED. FLOORING WARRANTIES DO NOT COVER MATERIAL WITH VISIBLE DEFECTS ONCE THEY ARE INSTALLED. THE ORIGINAL PURCHASER OF THE FLOORING IS RESPONSIBLE FOR FINAL INSPECTION OF FLOORING QUALITY AND GRADE. ANY EXCESS FLOORING SHOULD BE STORED IN A CLIMATE-CONTROLLED AREA FOR REPAIRS IN THE EVENT OF FUTURE DAMAGE.

ASBESTOS WARNING!

WARNING! EXISTING RESILIENT FLOORING MAY CONTAIN ASBESTOS FIBERS OR CRYSTALLINE SILICA. DO NOT SAND, DRY SCRAPE, DRILL, SAW, BEAD BLAST OR MECHANICALLY CHIP OR PULVERIZE ANY EXISTING RESILIENT FLOORING, BACKING, LINING FELT, OR ASPHALTIC "CUTBACK" ADHESIVE. AVOID CREATING DUST. INHALATION OF SUCH DUST IS A CANCER AND RESPIRATORY TRACT HAZARD. SMOKING BY INDIVIDUALS EXPOSED TO ASBESTOS FIBERS GREATLY INCREASED THE RISK OF SERIOUS BODILY HARM. UNLESS POSITIVELY CERTAIN THAT THE EXISTING PRODUCT IS A NON-ASBESTOS CONTAINING MATERIAL, YOU MUST PRESUME IT CONTAINS ASBESTOS. REGULATIONS MAY REQUIRE THAT THE MATERIAL BE TESTED TO DETERMINE ASBESTOS CONTENT. SEE THE CURRENT EDITION OF RESILIENT FLOOR COVERING INSTITUTE (RFCI) PUBLICATION "RECOMMENDED WORK PRACTICES FOR REMOVAL OF RESILIENT FLOOR COVERINGS" FOR DETAILED INFORMATION AND INSTRUCTION ON REMOVING ALL RESILIENT COVERING STRUCTURES.

THIS HOMESTEAD JETCORE DOES NOT CONTAIN HAZARDOUS MATERIALS SUCH AS ASBESTOS OR CRYSTALLINE

SUITABLE SUBSTRATES AND SURFACE MATERIALS

CONCRETE SUBSTRATES

- Homestead JetCore may be installed over on grade, above grade, or below grade concrete subfloors. A 6mil polyurethane moisture barrier **MUST** be used with concrete subfloors.
- Concrete must be permanently dry, clean, smooth, level, and free from all foreign materials such as dust, wax, glues, solvents, paints, grease, oils, and any chemical residues.
- New and existing concrete subfloors **MUST** meet the guidelines of the latest edition of ASTM F 2170 and ASTM 1869, “Standard Practice for Preparing Concrete Floors to Receive Resilient Flooring” available from the American Society for Testing and Materials, 100 Barr Harbor Drive, West Conshohocken, PA 19428; (610) 832-9585; <http://www.astm.org/>
- Concrete shall be finished and cured according to ACI and have a minimum compressive strength of 3500 psi. Installation of moisture barrier is recommended prior to pouring out on or below grade slabs. A 6mil polyethylene moisture barrier **MUST** be used with concrete subfloors. Moisture vapor transmission shall not exceed 8 lbs./1000 sq. ft./24 hours per ASTM F-1869 (Anhydrous Calcium Chloride Test). Moisture levels must also be tested according to ASTM F-2170 (American Standard Test Method for determining relative humidity in concrete floor slabs using in site probes). When testing according to this method, the internal relative humidity shall not exceed 85%. Homestead JetCore may be installed over gypsum-based underlayment’s.
- Holes, grooves, expansion joints and other depressions must be filled with a Portland based patching and leveling product, and troweled smooth and feathered even with the surrounding surface.
- Maximum acceptable pH levels of 9 or less. Refer to Resilient Floor Covering Institute Website at: <https://rfci.com/recommended-work-practices/>
- **DO NOT install over concrete with a history of high moisture or hydrostatic conditions.**

EXISTING FLOORS

Homestead JetCore may be installed over most smooth, single layer, hard surface existing flooring (tile, ceramic, marble, and terrazzo). Existing flooring must be moisture free and in good condition. Any residue (i.e. old glue) on subfloor must be completely removed. Check flooring for any curled areas around the perimeter or at seams and repair if necessary. Level by using a good quality cementitious based embossing leveler to smooth and fill the existing floor or grout lines. Tile may require several skim coats to achieve a flat surface. **JetCore requires a smooth and level subfloor for proper installation, subfloor cannot be more than 3/16” difference in level over a 10’x10’ area.**

WOOD SUBSTRATES

- Wood floors must be double constructed with a minimum thickness of 1” inch, free from spring/deflection. Top layer of plywood shall be ¼” inch minimum thickness underlayment grade plywood. Recommended underlayment’s include APA Underlayment Grade Plywood: A-C, B-C, or C-C plugged, ACCUPLY, SurePly, TECPLY, ULAY, C.S.A. (CanPly) and ProBoard.
- **DO NOT** install material over wood subfloors that lay directly on concrete or over sleeper construction. All subfloors must be structurally sound and installed following their manufacturer’s installation instructions. Local building codes may only establish minimum requirements of the flooring system and may not provide adequate rigidity and support for proper installation and performance.
- A moisture test is required using a pin-type moisture meter. The moisture content should be 13% or less.
- Joist Spacing should not exceed 19” inches. Use nail set for fasteners exposed above surface. Fill and sand gaps wider than 1/8” inch wide.
- If the surface of the wood subfloor is not smooth, a ¼” inch underlayment panel must be installed over the subfloor, per the underlayment manufacturer’s written instructions.
- Homestead JetCore™ should **NOT** be installed directly over fire-retardant treated plywood or preservative treated plywood. An additional layer of APA rated ¼” inch thick underlayment is recommended as a buffer between the two

RADIANT HEAT

Homestead JetCore can be installed over radiant heat. Please read through these special instructions when using a radiant heating system under the Homestead JetCore before the flooring installation.

PLEASE NOTE WHEN USING RADIANT HEAT:

- The subfloor surface temperature must never exceed 80 degrees Fahrenheit throughout the life of the floor.
- Homestead JetCore should never come in direct contact with the radiant heating system.
- Use of an in-floor temperature sensor is recommended to avoid overheating.

RADIANT HEAT SPECIAL INSTRUCTIONS:

1. Completed Radiant Heat System must be operational for a minimum of two weeks.
2. Radiant heat components must have a minimum of ½" inch separation from the product.
3. Radiant Heat System should be turned off for 72 hours prior to installation of Homestead JetCore and remain off for 72 hours after the Systems installation is complete.
4. After installation and 72-hour acclimation period, the radiant heat system can be turned on. We suggest to gradually increase the temperature in increments of 5°F to avoid overheating. Maximum operating temperature should never exceed 80° F.
5. Once this process is complete the Radiant Heat System can be used at its normal room temperature setting.
6. All other standard installations instructions apply.

BATHROOMS

When the Homestead JetCore is installed in a bathroom, the flooring can be laid under the toilet only if the floor is separated from adjacent rooms with a doorway threshold. Otherwise the flooring should be installed around the toilet leaving a 1/8" inch expansion space. Use a high-quality silicone caulking to fill the expansion space at the tub, shower and all wet areas to prevent surface water seepage under the floor.

STAIRS

Homestead JetCore can be installed when fully adhered over steps using a high quality pressure sensitive luxury vinyl tile adhesive such as Franklin® 780. Follow the instructions on the adhesive for trowel size and drying time. Always use a flush stair nose molding to finish each step at the nose.

PRODUCT RUN SPECIFICATION: THESE PLANKS CAN HAVE SLIGHT COLOR VARIATIONS BETWEEN PRODUCT RUNS. BEFORE STARTING THE INSTALLATION, IT IS BEST TO CHECK THE PRODUCT RUN NUMBER WHICH IS LOCATED ON THE LABEL ON THE SHORT SIDE (END) OF THE CARTON. IF YOU FIND THAT YOU HAVE CARTONS FROM DIFFERENT PRODUCTION RUNS, IT IS HIGHLY RECOMMENDED THAT YOU OPEN 3 – 4 CARTONS AND INSTALL A MIX OF PLANKS FROM EACH DIFFERENT PRODUCTION RUN ON YOUR FLOOR. THIS WILL RESULT IN A MORE NATURAL LOOKING FLOOR.

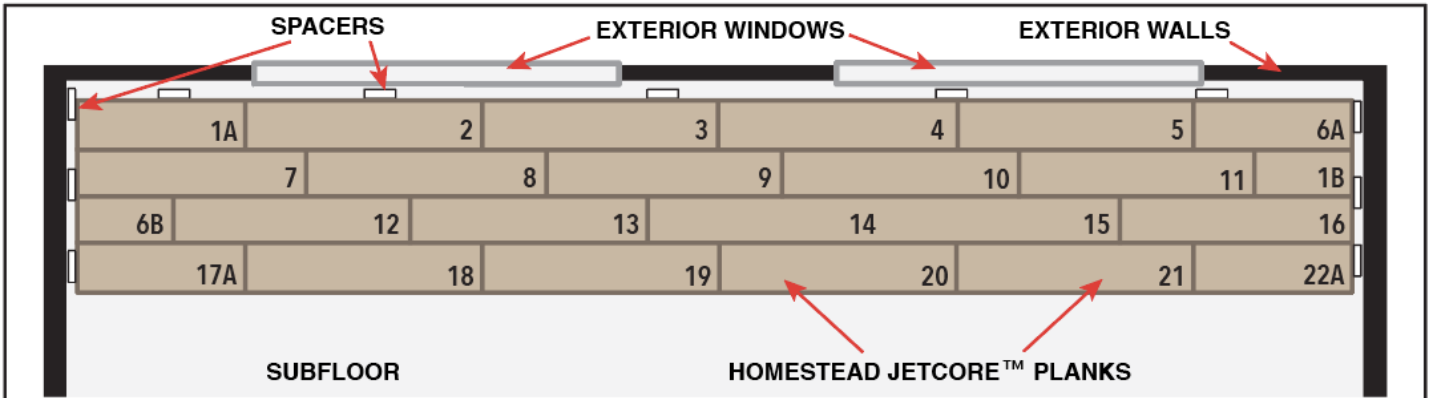

PLEASE NOTE: 1A, 1B, 6A, 6B, 17A, and 22A - Are Cuttings from full planks, cut planks can be no shorter than 8"

FIGURE 1

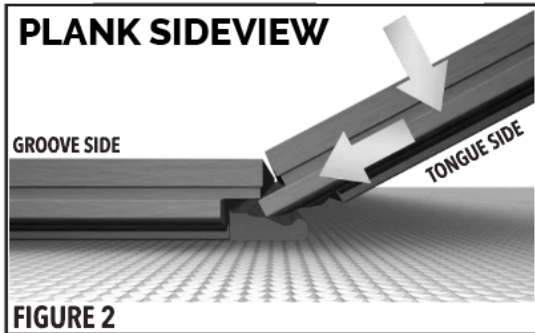

FIGURE 2

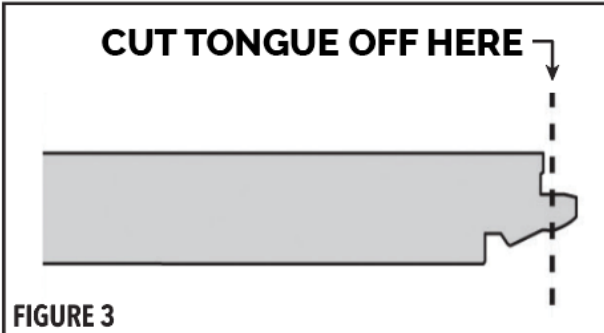

FIGURE 3



You can use a smart phone to scan this QR code with the "Photo App" to view a Uniclic™ Angle/Angle Installation video. Or search YouTube for "Homestead Flooring Installation"

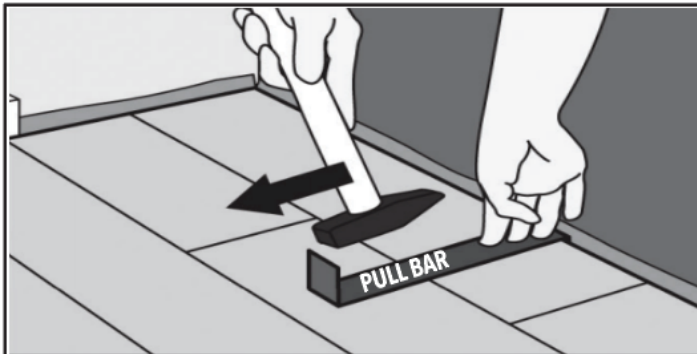

FIGURE 5A

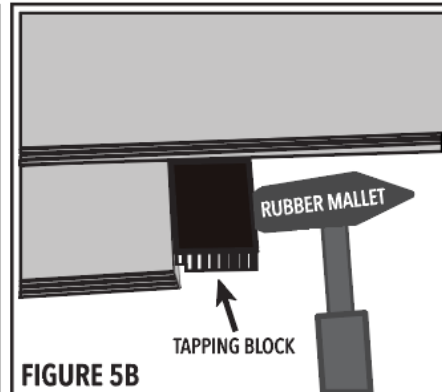

FIGURE 5B

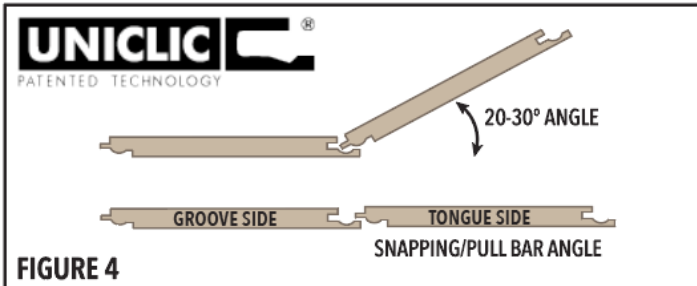

FIGURE 4

INSTALLATION TOOLS

- | | |
|-----------------------|-----------------------|
| 1. UTILITY KNIFE | 6. SAFETY GLASSES |
| 2. TAPE MEASURE | 7. TAPPING BLOCK |
| 3. 1/4" SPACERS | 8. RUBBER Mallet |
| 4. T-SQUARE | 9. PULL BAR |
| 5. LONG STRAIGHT EDGE | 10. PERIMETER SPACERS |
| | 11. CHALK PEN |



GETTING STARTED

- Determine which direction the planks will be installed. To make the room appear larger or if installing in very small rooms or hallways, it is preferable to lay the planks parallel to the longest room dimension.
- Carefully measure the room to determine squareness and to determine the width of the last row of planks. If the width of the last row of planks is less than 2" inch (50mm), excluding the tongue, the width of the first row of planks will have to be cut accordingly.
- A minimum of 1/4" expansion space is required around the perimeter of the room and all vertical objects (i.e. pipes and fixtures).
- Inspect all planks for visible defects and damage before and during installation. DO NOT install damaged planks. The manufacturer will not accept responsibility for claims on flooring installed with obvious defects. During installation, inspect the groove area and remove any debris that may prevent proper assembly of planks.

INSTALLATION STEPS

1. Begin installation parallel to the long dimension of the room, preferably parallel with the light sources (windows & doors) (Refer to Figure 1). Snap a chalk line at the starting point to maintain alignment. Use planks mixed in from four or five cartons to achieve the ideal random pattern.
2. Install planks from the left side of the starting wall and work to the right side. If starting with a full width plank, the tongue must be removed (Refer to Figure 3). To trim planks, use a utility knife and a straight edge. Score the top surface of the plank, flex it downward to separate pieces. The tongue side of the plank always faces the starting wall. Place 1/4" inch (8.2mm) spacers between the short and long side of the planks and the wall. Always position one spacer between the wall and where the planks join.
3. Be sure to maintain a 1/4" inch expansion space around all walls and vertical objects and maintain a random appearance by cycling patterns of boards. Offset end joints a minimum of 8" inch (20.3cm).
4. The end joints of the planks in the first row are assembled by inserting the tongue side into the groove side of the previous plank at a low 20-30° degree angle. Gradually lower the plank down flat, applying pressure inward and downward clicking and locking the end of the new plank into the end of the existing plank until the end joint closes. Ensuring that the planks are perfectly aligned. Install remaining full planks in the first row (Refer to Figure 4).
5. The last plank in the first row may need to be cut. Measure the distance between the wall and the surface of the last full plank. Subtract 5/16" inch (8.2mm) from this measurement to allow for the spacer. If this measurement is less than 8" inches (20.3cm) long. (Refer to Figure 1)
6. When installing the first plank-cutting cut off from the last or first plank in the first row may serve as the first or last plank in the second row provided it is at least 8" inches (20.3cm) long. Always stagger end joints from row to row a minimum of 8" inches (20.3cm) long. (Refer to Figure 1)
7. When installing the first plank of the second row, remember to place a 1/4" inch spacer between the wall and the short side of the plank. Insert the long side tongue into the groove side of the plank in the first row at a low angle and lower flat to the substrate. Shift the plank down toward the end seam and slightly lift the previous plank in order to engage the end joints together.
8. Install the second plank of the second row. Position the long side of the second plank with the tongue side of the existing plank overlapping the groove of the planks in the previous row approximately 1/8" inch. Then, angle the end joint into the previous plank. Angle the plank down and gently push in until the plank locks into the previous row (Refer to Figure 2). Continue installing remaining planks in the second row.

IT IS VERY IMPORTANT TO MAKE SURE THAT THE FIRST TWO ROWS ARE STRAIGHT AND SQUARE, OR THIS WILL ADVERSELY AFFECT THE ENTIRE INSTALLATION. THE FIRST TWO ROWS ARE THE "INFRASTRUCTURE" FOR THE REST OF THE INSTALLATION. NOTE TO CHECK STRAIGHTNESS AND SQUARENESS REGULARLY. (REFER TO FIGURE 1)

9. Continue working from left to right, row by row, making sure to install the planks with the long side seam first, then slide back to drop the end joint into place. Tap the ends to ensure a tight fit.
10. If the boards are only a little tight, first try tapping with your hands, as the flexibility and convenient connection of the Unilin™ click system become evident in tight spaces. If need be use the tapping block and rubber mallet on the end joints to ensure a tight fit. DO NOT tap using only the rubber mallet, a tapping block is an important buffer between the plank and mallet to prevent damages to the planks.

PLEASE NOTE: IF YOU CANNOT FIND A TAPPING BLOCK, A SCRAP PIECE OF FLOORING CAN WORK.

11. Homestead JetCore is unique in that difficult areas they can be installed with a pull bar or tapping block and rubber mallet. Use of a pull bar and rubber mallet to lock the joints together in the last row may be necessary. Always use a pull bar on the cut edge of the plank. Factory edges can be damaged if the pull bar is used directly against them. (Refer to Figure 5A and 5B)

POSSIBLE AREAS OF DIFFICULTY: THE LAST ROW AND WHEN FITTING AROUND DOOR TRIM. WHEN FITTING AROUND A DOOR TRIM IT WILL BE NECESSARY TO SLIDE THE PLANK UNDER THE TRIM. THIS CAN BE ACCOMPLISHED EASILY BY STARTING THE ROW ON THE SIDE OF THE ROOM WITH THE DOOR TRIM AND THEN SLIDING THE PLANK INTO PLACE ONCE IT IS ATTACHED. THE ROW CAN BE COMPLETED BY INSERTING THE TONGUE INTO THE GROOVE OR THE GROOVE INTO THE TONGUE DEPENDING ON THE DIRECTION. A SPECIAL UNILIN® APPROVED TAPPING BLOCK AND PULL-BAR CAN ALSO BE USED TO LOCK THE JOINTS TOGETHER WHILE THE PLANKS ARE IN A FLAT POSITION. USE A SERIES OF LIGHT TAPS UNTIL THE JOINT IS GRADUALLY LOCKED TOGETHER. (REFER TO FIGURE 5A AND 5B)

FINISHING THE INSTALLATION

- After the planks have been installed, remove spacers from perimeter of room.
- Protect all exposed edges of the flooring by installing wall molding and/or transition strips.
- Pre-drill and install quarter round or baseboard molding. Molding must be sufficient size to cover the ¼" inch space. DO NOT Fasten moldings through the flooring. Fasten into the wall.
- If not covering exposed edges with trim, fill the gap with a high-quality silicone caulking.
- Use plywood to cover the top of the flooring when moving heavy furniture or appliances into position.
- Use proper non-staining floor protectors under the legs of furniture.
- Post installation temperature MUST be maintained between 55° - 85° F. Relative humidity must be maintained between 40% and 70%.
- Protect the finished installed flooring from exposure to direct sunlight, or tiles may expand or shift.
- For wet areas such as bathrooms, make sure to caulk the perimeter of the floor with a high-quality silicone caulking.

FLOOR CARE

- Frequently moved furniture should be equipped with felt pads to avoid scratching the floor. Heavy furniture and appliances should be equipped with non-staining large surface floor protectors. Furniture with castors or wheels must be easy swiveling and suitable for resilient floors. DO NOT use ball type castors as they can damage the floor.
- Avoid exposure to long periods of direct sunlight. Close blinds or drapes during peak sunlight hours.
- Use vinyl friendly (non-rubber) walk off mats at entrances to prevent dirt and grit from being tracked onto the floor.
- Sweep or vacuum the floor regularly to remove loose dirt. Avoid using a vacuum with a beater bar.
- Clean up spills immediately.
- Damp mop as needed using clean water and a diluted vinyl floor cleaner.
- DO NOT use harsh cleaners or chemicals on the floor. DO NOT use vinegar-based products.
- DO NOT use industrial floor machines.

PLANK REPLACEMENT

In cases of severe damage, tiles may be replaced by cutting the bad piece out using a utility knife. To insert a replacement tile, cut the tongue off the new piece and use a seam sealer on only the side of the tile, adhering the new tile into place.

FOR MORE INFORMATION VISIT: www.HOMESTEADFLOORING.com